

Comfort Series SUBMITTAL DATA

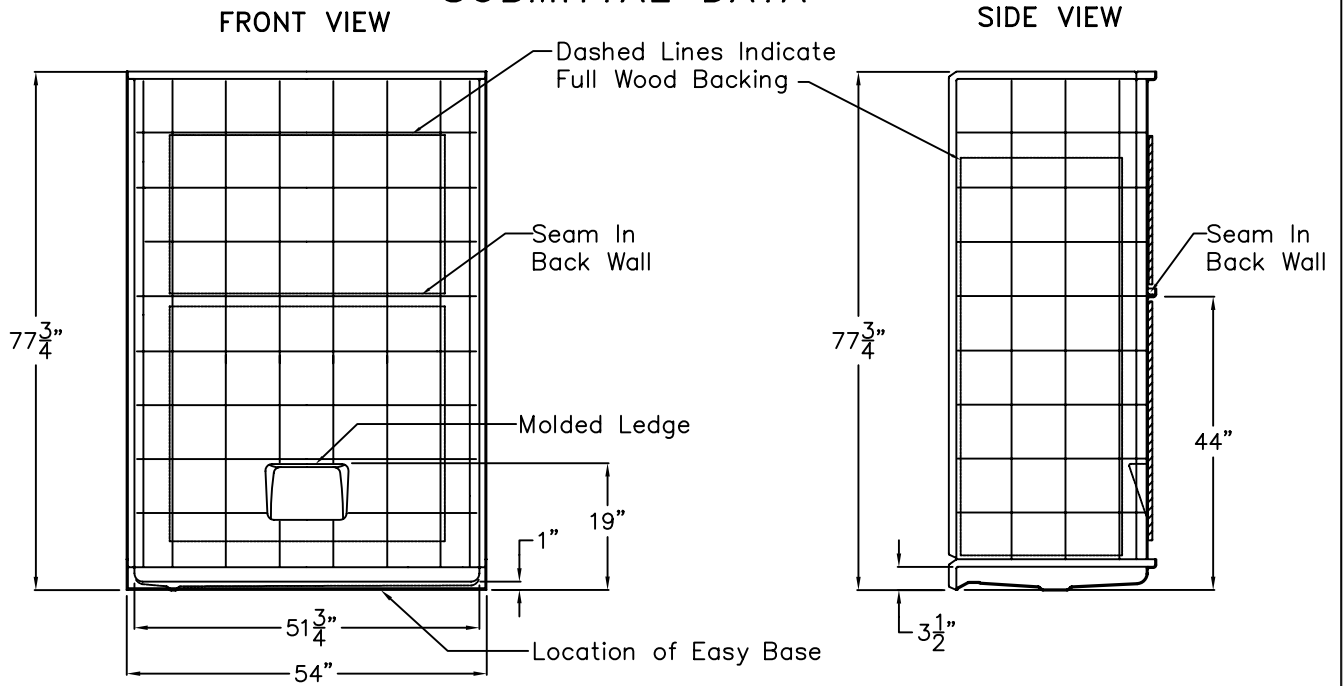

Barrier Free Sectional Shower Stall

The shower enclosure shall be RBS 5430 BF 1.0 Five Piece, Right, Left Drain. Finished surface shall be of a sanitary-grade polyester Gelcoat exhibiting a minimal thickness of 15 dry mils, and a finished cured Barcol hardness of 80-90 as tested with ASTM D-2583. Unit construction shall be of molded reinforced fiberglass with a 15% minimum fiberglass content. The unit shall have outside dimensions of 54" x 31" x 77 3/4". The five piece unit shall meet ANSI Z124.2, NAHB, UPC, and shall meet the requirements of Southern Building Code.

The enclosure shall be equipped with the following installed accessories:

- 1) 1" Threshold, 2) Tile Finish, 3) Two Piece Back Wall, 4) Full wood backing on walls, 5) Left or right drain location, 6) Easy Base self-sustaining bottom, 7) lower molded ledge on back wall.

TOP VIEW

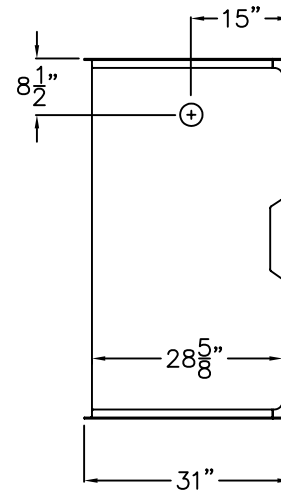

Detail of 1.0" Threshold

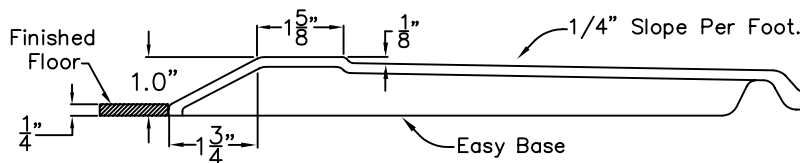

DUE TO THE NATURE OF THE MATERIALS INVOLVED
UNIT DIMENSIONS MAY VARY ± 1/2 INCH

Renovative Bath Systems

Model No.:

Drawing#: RBS 5430 BF 5P 1.0 FWB
Left or Right Drain Easy Base

Approved by:

Date Approved:

Date: 3-31-09

Revised: 8-9-13

Rep.:

Wholesaler:

Quote No.

RENOVATIVE BATH SYSTEMS
Richmond Va.
1 800 441 8673

Board Placement Drawing

SUBMITTAL DATA © 2004

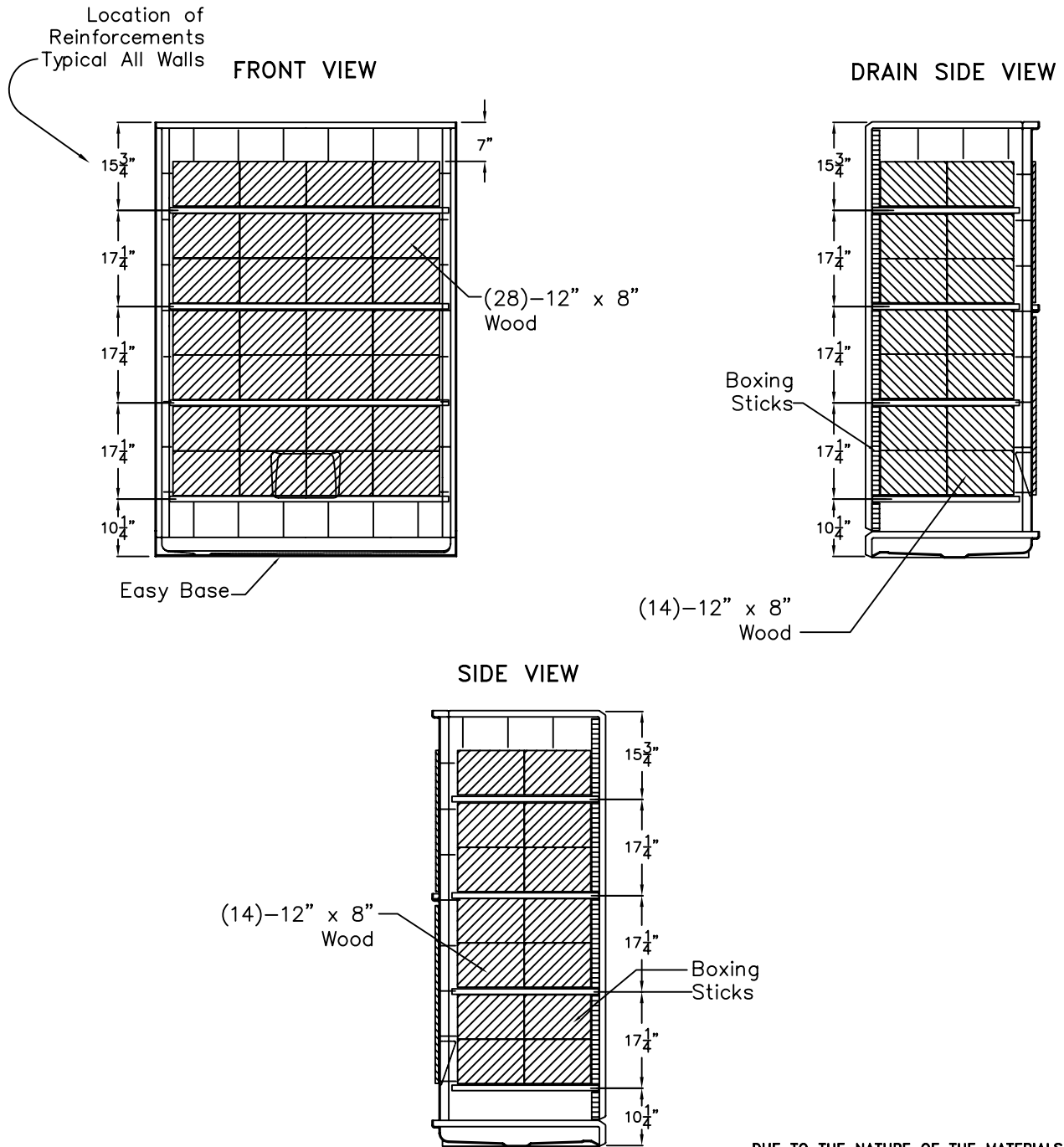

DUE TO THE NATURE OF THE MATERIALS INVOLVED
UNIT DIMENSIONS MAY VARY ± 1/2 INCH

Job Name:	Renovative Bath Systems
Model No.:	Drawing#: RBS 5430 BF 5P 1.0 FWB Left or Right Drain Easy Base-BP
Approved by:	Date Approved:
Rep.:	Wholesaler:
	Quote No.:

RENOVATIVE BATH SYSTEMS
Richmond Va.
1 800 441 8673